

Proposed Annexation Map, 1 of 4

City of Ellisville, St. Louis County Missouri

City of Wildwood

City of Ellisville

Rockwood School District
Learning Center

Rockwood School District
Ridge Meadows Elementary

Legend

-  Ellisville
-  Proposed annexation

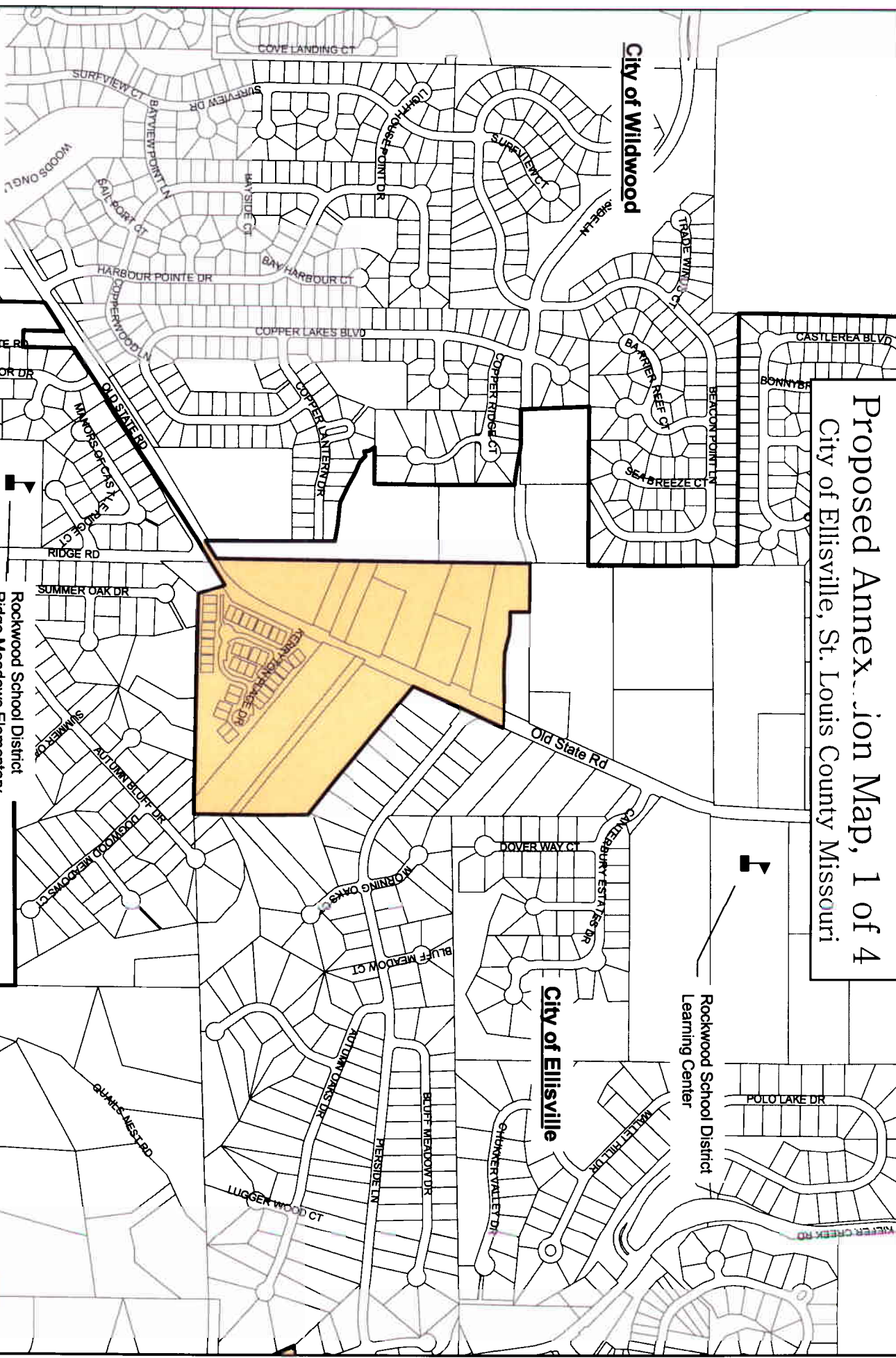

Proposed Annexation Map, 2 of 4

City of Ellisville, St. Louis County Missouri

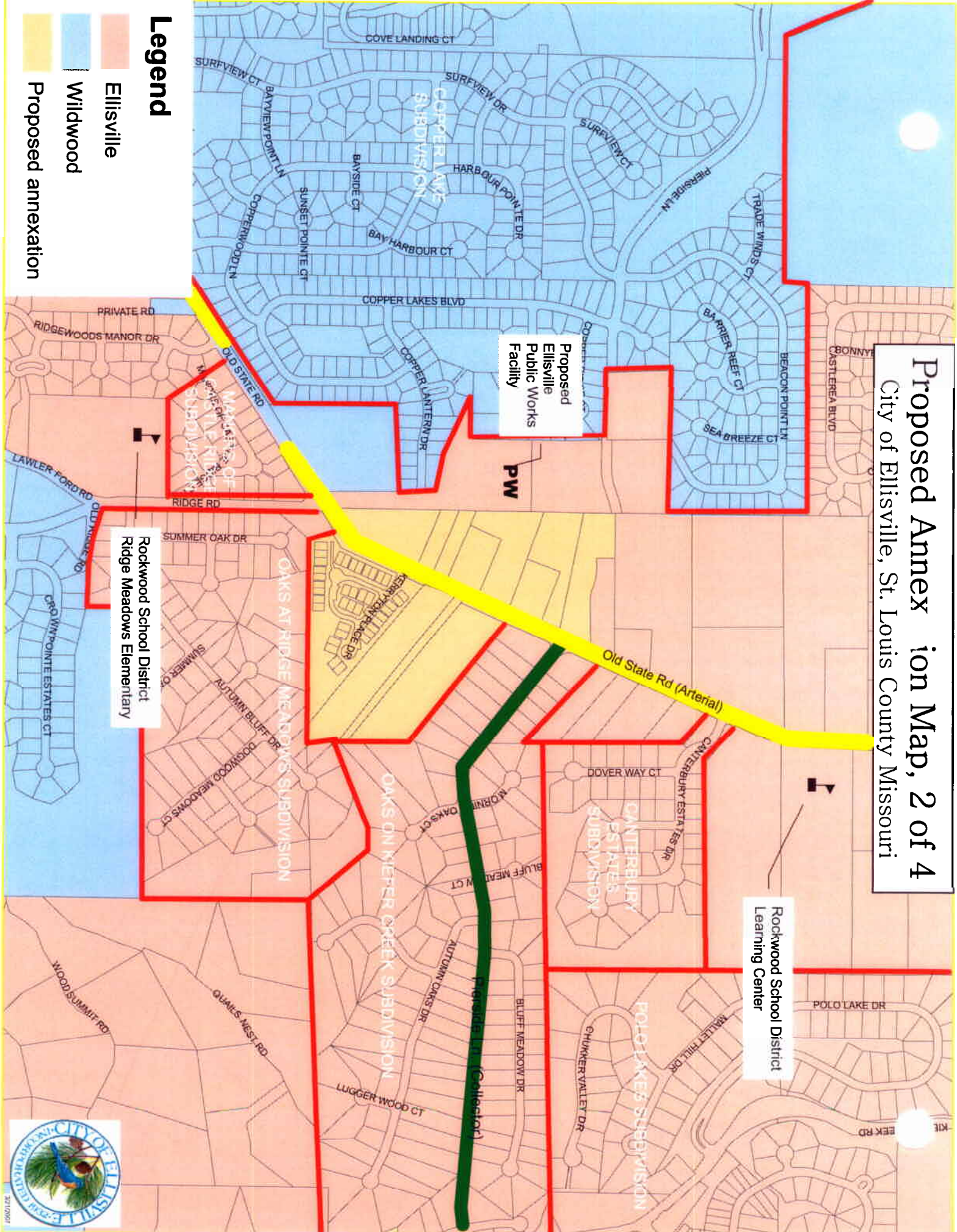

Legend

- Ellisville
- Wildwood
- Proposed annexation

Proposed
Ellisville
Public Works
Facility

PW

Rockwood School District
Ridge Meadows Elementary

Rockwood School District
Learning Center

Old State Rd (Arterial)

Collector



A tract of land being part of Section 5, Township 44 North, Range 4 East, St. Louis County, Missouri, and being more particularly described as follows:

Beginning at the northwest corner of Lot 2 of Old State Industrial Court as recorded in Plat Book 197, Page 9; thence leaving said northwest corner in an easterly and southeasterly direction along the north line of said Lot 2 and the prolongation of said north line to the intersection of said north line prolongation with the east right-of-way of Old State Road; thence along said east right-of-way in a southwesterly direction to the westernmost corner of Tract B of the Oaks on Kiefer Creek as recorded in Plat Book 289, Page 54; thence leaving said east right-of-way in a southeasterly direction along the west line of said subdivision to an angle point on the west line of Lot 122 of The Oaks on Kiefer Creek; thence continuing along the west line of The Oaks on Kiefer Creek and the prolongation thereof in a southerly direction to the southeast corner of a tract of land conveyed to Napoli in Deed Book 16360, Page 856; thence along the south line of said Napoli tract and the south line of Kerryton Place Villas as recorded in Plat Book 349 Pages 417 through 419 in a westerly and northwesterly direction to the intersection of said south line with the east right-of-way of Old State Road; thence leaving said south line in a southwesterly direction along the east right-of-way of Old State Road to the intersection of said east right-of-way with the prolongation of the west line of Krupp Subdivision as recorded in Plat Book 347, Page 217; thence leaving said east right-of-way in a northerly direction along the prolongation of said west line to the southwest corner of Lot 2 of Krupp Subdivision, said point also being on the west right-of-way line of Old State Road; thence along said west right-of-way to the southeast corner of Lot 2 of Krupp Subdivision; thence leaving said west right-of-way in a northerly direction along the east line of Krupp Subdivision and its prolongation to the point of beginning, containing approximately 42 acres, and having a perimeter distance of approximately 6,519 feet.

ATTACHMENT TO NOTICE

DESCRIPTION:

Legal Description

DESCRIPTION:

A tract of land being part of Section 5, Township 44 North, Range 4 East, St. Louis County, Missouri, and being more particularly described as follows:

Beginning at the northwest corner of Lot 2 of Old State Industrial Court as recorded in Plat Book 197, Page 9; thence leaving said northwest corner in an easterly and southeasterly direction along the north line of said Lot 2 and the prolongation of said north line to the intersection of said north line prolongation with the east right-of-way of Old State Road; thence along said east right-of-way in a southwesterly direction to the westernmost corner of Tract B of the Oaks on Kiefer Creek as recorded in Plat Book 289, Page 54; thence leaving said east right-of-way in a southeasterly direction along the west line of said subdivision to an angle point on the west line of Lot 122 of The Oaks on Kiefer Creek; thence continuing along the west line of The Oaks on Kiefer Creek and the prolongation thereof in a southerly direction to the southeast corner of a tract of land conveyed to Napoli in Deed Book 16360, Page 856; thence along the south line of said Napoli tract and the south line of Kerryton Place Villas as recorded in Plat Book 349 Pages 417 through 419 in a westerly and northwesterly direction to the intersection of said south line with the east right-of-way of Old State Road; thence leaving said south line in a southwesterly direction along the east right-of-way of Old State Road to the intersection of said east right-of-way with the prolongation of the west line of Krupp Subdivision as recorded in Plat Book 347, Page 217; thence leaving said east right-of-way in a northerly direction along the prolongation of said west line to the southwest corner of Lot 2 of Krupp Subdivision, said point also being on the west right-of-way line of Old State Road; thence along said west right-of-way to the southeast corner of Lot 2 of Krupp Subdivision; thence leaving said west right-of-way in a northerly direction along the east line of Krupp Subdivision and its prolongation to the point of beginning, containing approximately 42 acres, and having a perimeter distance of approximately 6,519 feet.

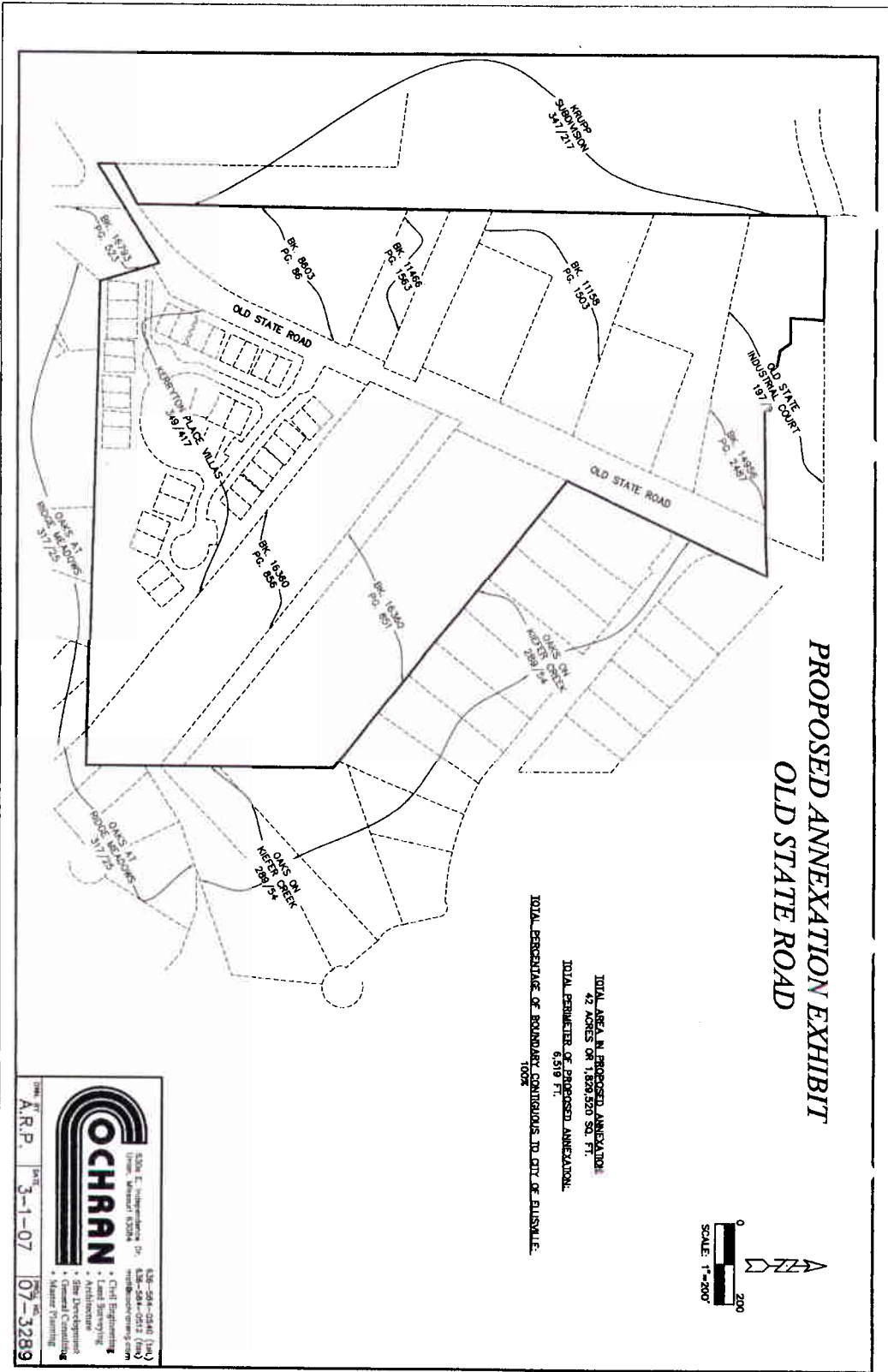

Survey Map to Accompany Legal Description