

Figure 5

# CONSERVATION EASEMENT EXHIBIT

N/F  
STATE OF MISSOURI  
DEED BK 6760, PG 2143  
LOC NO. 27R530020  
125 BALD EAGLE RIDGE RD

N/F  
CENTERRE TRUST COMPANY OF ST LOUIS, AS TRUSTEE  
C/O MARK SIMPSON  
DEED BK 8404, PG 320  
LOC NO. 27R640031  
441 N OUTER ROAD

U.S. SURVEY 985,  
T44N, R4E, 5th P.M.

N/F  
WEST OUTER ROAD LLC  
C/O MARK T SIMPSON  
DEED BK 17922 PG 3134  
DOC NO. 2008062500927  
LOC NO. 27R640020  
501 N OUTER ROAD

157.204± ACRES

N/F  
ST. LOUIS COUNTY  
DEED BK 5300,  
PG 34  
LOC NO. 27R130015  
1 LONE  
ELK PARK

SEC. 24,  
T44N, R4E,  
5th P.M.

SEC. 25,  
T44N, R4E,  
5th P.M.

POB  
CONSERVATION  
EASEMENT  
DESCRIPTION

U.S. SURVEY 879,  
T44N, R4E, 5th P.M.

CONSERVATION EASEMENT  
3,148,697 S.F.  
72.284 ACRES

**LEGEND**

- SECTION LINE
- - - ESMT. LINE
- BLDG. SETBACK
- PROPERTY LINE
- FND. IRON ROD
- ⊙ FND. IRON PIPE
- ▲ FND. OLD STONE
- ⊕ FND. BOLT
- ⊗ FND. R/W MARKER
- FND. CONC. MON.

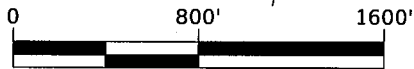

SCALE: 1" = 800'

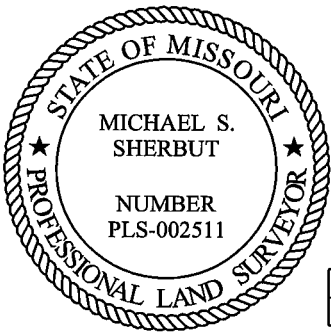

LINE	BEARING	DISTANCE	LINE	BEARING	DISTANCE
L1	N00°51'55"E	1059.27'	L12	S80°29'13"E	748.71'
L2	S83°35'35"W	451.34'	L13	S57°02'16"E	190.79'
L3	N23°10'49"E	1886.11'	L14	S26°26'59"E	107.17'
L4	S82°17'01"E	207.51'	L15	S61°42'04"W	1241.37'
L5	S23°10'49"W	591.18'	L16	S80°28'45"W	211.24'
L6	S00°51'55"W	1337.72'	L17	S66°39'16"W	602.25'
L7	S89°08'05"E	490.00'	L18	S28°17'56"E	160.00'
L8	N66°39'16"E	1530.21'	L19	S61°42'04"W	1503.04'
L9	N80°28'45"E	193.60'	L20	S61°42'04"W	541.38'
L10	N61°42'04"E	1108.55'	L21	N01°04'38"E	302.52'
L11	N09°30'47"E	288.29'			

CURVE	RADIUS	LENGTH	DELTA	EX. TAN.	CRD. BEARING	CRD. DISTANCE
C1	3004.98'	799.23'	15°14'20"	401.99'	S69°19'14"W	796.88'

*Michael S. Sherbut* 08-13-2019

MICHAEL S. SHERBUT, PLS  
PROFESSIONAL LAND SURVEYOR  
NO. 002511 - STATE OF MISSOURI

**NOTES:**

- THIS EXHIBIT DOES NOT REFLECT ANY UNDERGROUND UTILITIES, EASEMENT OF RECORD OR OTHER ENCUMBRANCES THAT MAY AFFECT THE SUBJECT TRACT.
- REFERENCE IS MADE TO THE DESCRIPTION OF EVEN DATE ACCOMPANYING THE SKETCH.

PAGE 3 OF 3

SIMPSON MATERIALS COMPANY  
926 SOUTH HIGHWAY DRIVE  
FENTON, MISSOURI 63026  
LOCATOR NO. 27R640020  
ST. LOUIS COUNTY, MISSOURI

**VOLKERT**

1500 EASTPORT PLAZA DRIVE  
SUITE 200  
COLLINSVILLE, IL 62234  
618.345.8918  
MO PLS CORP NO 2015022764